

MAINTENANCE INSTRUCTION

- 1.Do not use acetone, ammonia and organic solvent, clean the bathroom with liquid detergent and soft cloth. Do not use formate and methanal–include sanitizing compound.
- 2.Prevent it from exposure and frost.
- 3.Abrasion and burn on the surface can be removed, sand that place with No.1200 waterproof abrasive paper, then use No.2000, after that, polish it with soft cloth and polishing paste.
- 4.Plated components maintenance: do not use rough cloth, wipe with flannelette.
- 5.Tub maintenance: sand the abrasion with No.2000 waterproof abrasive paper, spread on polishing paste or toothpaste, then polish with flannelette.
- 6.Do not crush with sharp tools

TROUBLE ELIMINATE

Phenomena	Reason	Obviation measures
Water pump is out of service	1.The power supply wasn't connected well, the creepage switch was cut off. 2.The impeller of the water pump was blocked by rubbish. 3.Forget to press the drainer pump switch. 4.Water pump obviatin. 5.The gas pie isn't connected with gas switch wall leaking gas. 6.the pin of the power supply is disssconnected or power supplied abnormally.	1.Turn on the power supply 2.Clean the impeller. 3.Connect the water pump switch. 4.repair or change water pump. 5.connect the pipe with starup switch.
The massage intensity can't be adjusted	1.volage is abnormal. 2.adjusting switch is turn off or broker. 3.blockwater set is blocked.	1.Inspect the volage. 2.Inspect or change adjusting switch. 3.Clean backwater set.
Water pipe is aleak	1.Airproof circle is bad. 2.Screw isn't locked tightly. 3.The connection isn't sticked tightly.	1.Change airproof circle 2.Lock screw tightly. 3.Stick it tightly again.

Massage bathtub

Q313

INSTALLATION & USING INSTRUCTION

1700 × 900 × 710mm



- FUNCTION:
- Surf massage
 - Waterfall inlet
 - Trasferable switch
 - Multi function sprinkler
 - Manual outlet
 - Hydrodynamic adjust
 - Pneumatic switch
 - Cold/Hot water adjust
 - Control panel
 - Underwater light
 - Air bubble massage
 - Radio

PREFACE

We appreciate your selection for your using our massage bathtub productions of our company. Please read this introduction in details to make sure that you can use our productions safely and effectively, noticing following issues:

1) The qualified maintenance service is always available. Considering your interest, please fill out the warranty sheet carefully. If any other kind of service is required, you can connect to the distributor or us.

2) The damage or failure that is caused by incorrect voluntary installation or improper usage is out of our liability.

3) Accompany to our original components for utilization results perfection.

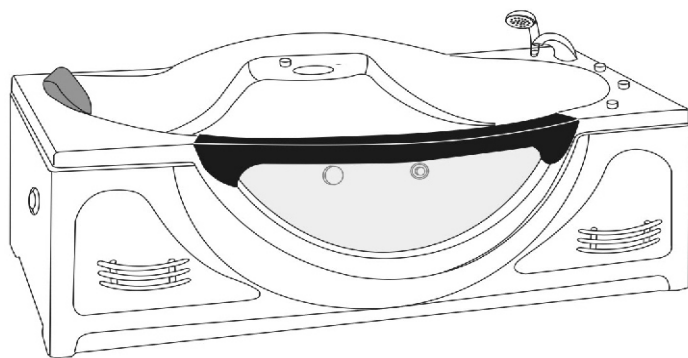

Operation

● Pneumatic switch



Press the above button of pneumatic switch then massage function turned on; Press the button again, then turned off.
(Only for the model with pneumatic switch)

● Drainage

Manual drainage

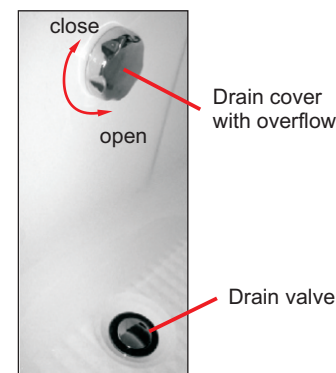

Rotate the cover clockwise to close the drain;
Rotate the cover anticlockwise to open the drain;
When the water is over the maximum water level, the excess water will be drained by overflow.

Accessories instruction

● Hydro massage flow rate control switch



Rotate hydro massage flow rate control switch clockwise, then the water column strength smaller; rotate the knob anticlockwise, then the water column strength stronger.
(Only for the model with hydro massage flow rate control switch)

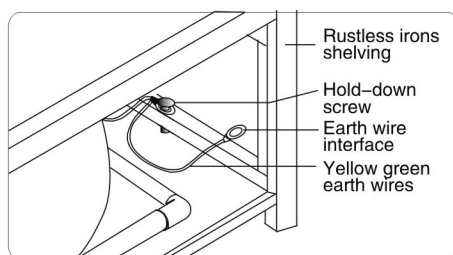
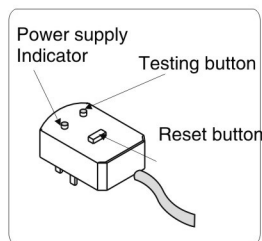
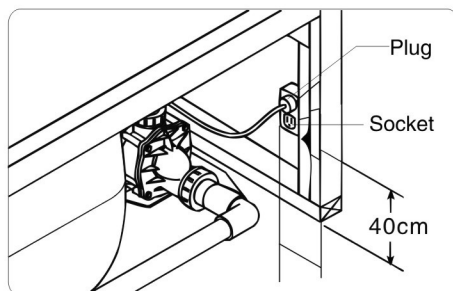

3 EARTH WIRE CONNECTION ILLUSTRATION

Limited to AC220V/50Hz current strength. Plunge the plug into socket (avoid water), press the electricity leakproof reset button, and then it is light. Notice that the yellow green two wires attached to motor are earth wire, the short one should connect to the rustless iron shelving, the other connect to earthing conductor.

4

Please make sure each interface is sealed, clear out the tub and water it, unblock the pump, pipe and nozzle completely.

5

Shut the sewer pipe and store water, open the pump when water has immersed all nozzles. After confirming every function working, empty the tub and move it to the right place. Spread neutral gas-protective glass cement on the connection of the tub and wall, utilization is allowed after 24 hours.

OPERATION INTRODUCTION

1. UTILIZATION OF FAUCET

If your inlet pipes of cold/hot water are connected according to instruction, the switch marked red is hot water switch, the one marked blue is cold water switch. Rotate these two switches to adjust the pressure of water.

Transferable switch beside waterfall inlet can be rotated to waterfall or sprinkling style.

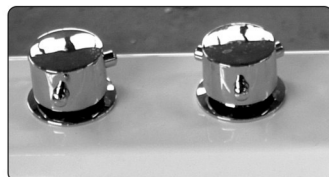

SAFETY INSTRUCTION

1. Only qualified professionals or appointed by distributors are allowed to do the electric security adjustment.

2. Make sure that the power supply meets the national security criteria, the voltage and frequency fit for our products (resorts to the electric parameter on P3). Our production must be installed with electricity leakproof switch, overcurrent and overload fuse, to ensure the effectiveness of those equipments.

3. Do not cut down any connection wire and disassemble the bus master and control panel when the bathroom is working (no components of the bus master and control panel can be disassembled by users); otherwise, our company will not take on any related liability for the production failure, electricity leak or electric shock or other incident.

4. Avoid the organic solvent: acetone, ammonia and gasoline, strong acid chemical, etc. They can erode acrylics parts and electroplated components.

5. Keep upright, not to be tipped, not to be stowed below cargo, acid with care, do not crush, vibrate and crash.

6. If you do not use it, keep breezy and dry, no perishable gas, no electricity and water.

7. Forbid non-professionals from installing. Professional can solve the quality problems.

8. Test the electricity leakproof equipment before using.

9. Do not extend wire privately. Motor with more than one square millimeter's copper wire can be connected to the earth.

10. Child using it must under the supervision of their parents.

INSTALLATION PREPARATION

1) Confirm the place equipped with water resource, electricity and sewer pipe. We recommend the addition of triangle valve to facility the maintenance. Use AC220V/50Hz current strength. Consult the electric parameter. Make sure the dewatering valve outlet fits the sewer pipe.

2) We apply to integrated assemble technology, each component is tested before outgoing. Please check the specification, size and location before using.

3) Please check the integrity of components. Inform our company if any problem happens.

Make sure the installation place can shoulder adequate strength. The overall weight accounts for bathtub, water and the user.

SCHEMATIC ILLUSTRATION

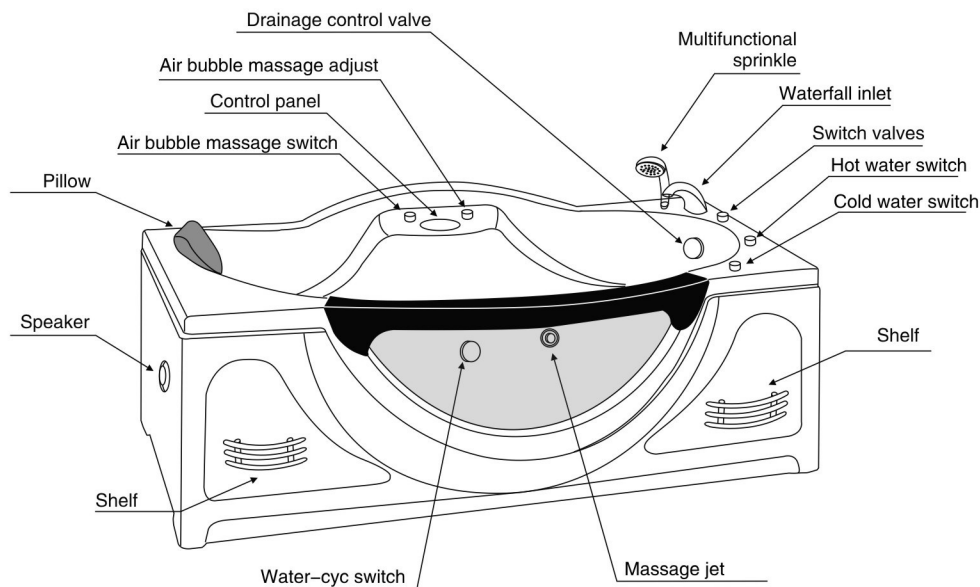

WATER AND ELECTRICITY SYSTEM INSTALLATION ILLUSTRATION

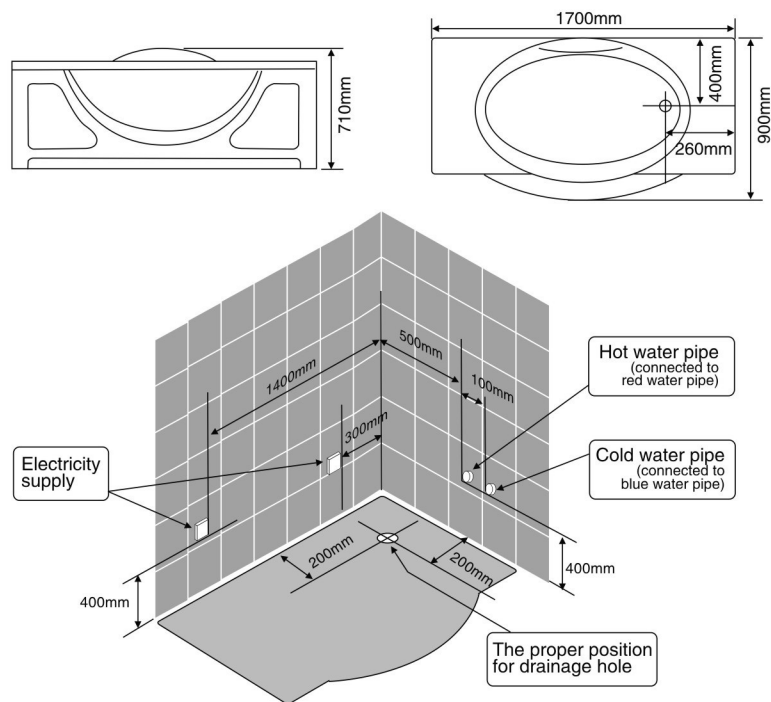

INSTALLATION ILLUSTRATION

1 ADJUST THE LEVEL OF BOTTOM TUB

Move the tub to the right place, adjust the nut of the grounded screw to make its head even.

Joint the cold-water pipe and hot-water pipe to the massage tub relatively.

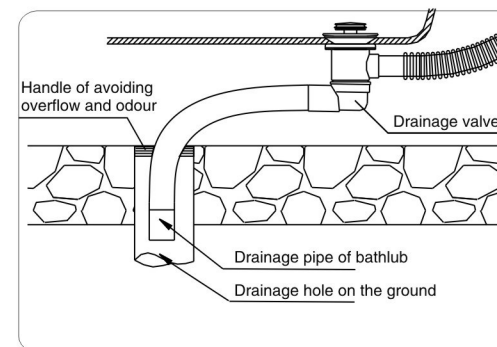
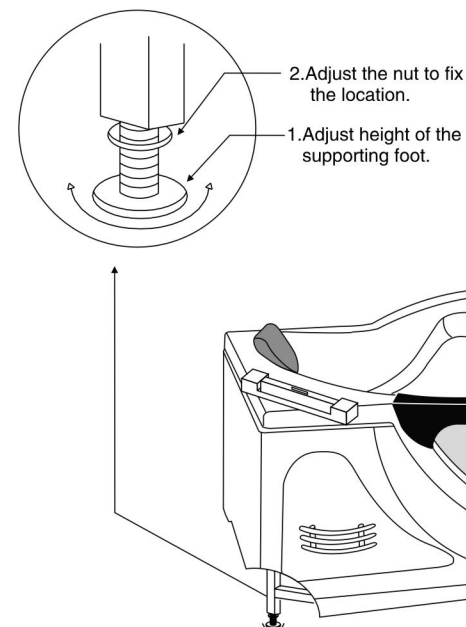

2 INSTALLATION SKETCH OF DRAINAGE PIPE

Insert the drainage pipe of the bathlud into the drainage hole on the ground, and seal it to avoid overflow and odour.